

DATE	10/08/2023
DRAWN BY	JSH
CHECKED BY	JSH
FILE NAME	2307155
JOB NO.	2307155

HARRIS GRAY, LLC
 ENGINEERS • SURVEYORS • PLANNERS
 OFFICE: 1100 N. W. 10TH AVENUE, SUITE 100, WEST PALM BEACH, FLORIDA 33411
 PHONE: (561) 965-5885

WHITESVILLE ROAD SOCCER COMPLEX
 TROUP COUNTY, LAGRANGE GA.
SITE PLAN OVERALL

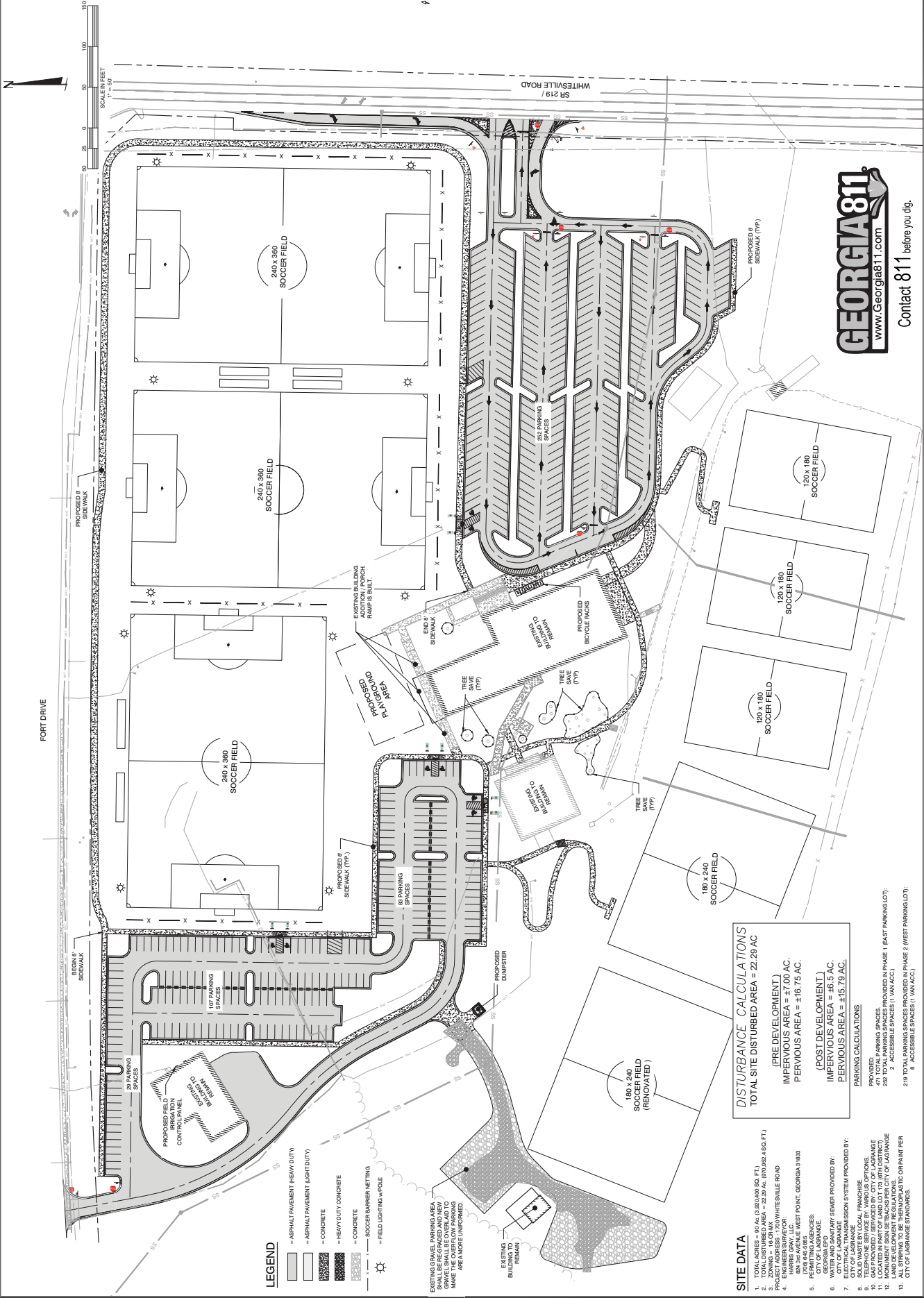

GEORGIA811
 www.Georgia811.com
 Contact 811 before you dig.

LEGEND

- ASPHALT PAVEMENT (HEAVY DUTY)
- ASPHALT PAVEMENT (LIGHT DUTY)
- CONCRETE
- HEAVY DUTY CONCRETE
- CONCRETE
- SOCCER BARRIER NETTING
- FIELD LIGHTING POLE

EXISTING GRAVEL PARKING AREA TO BE REMOVED AND REPLACED WITH ASPHALT PAVEMENT TO MAKE THE OVERFLOW PARKING AREA MORE UNIFORM.

EXISTING BUILDING TO REMAIN

SITE DATA

- TOTAL ACRES = 60 AC. (3,600,000 SQ. FT.)
- TOTAL DISTURBED AREA = 22.29 AC. (90,036,450 SQ. FT.)
- PERVIOUS AREA = 37.00 AC.
- PERVIOUS AREA = 16.75 AC.

PARKING CALCULATIONS

232 TOTAL PARKING SPACES PROVIDED IN PHASE 1 (EAST PARKING LOT)
 471 TOTAL PARKING SPACES PROVIDED IN PHASE 2 (WEST PARKING LOT)
 117 ACCESSIBLE SPACES (1 IN PHASE 1, 116 IN PHASE 2)
 117 ACCESSIBLE SPACES (116 IN PHASE 1, 1 IN PHASE 2)

DISTURBANCE CALCULATIONS

TOTAL SITE DISTURBED AREA = 22.29 AC
 (PRE DEVELOPMENT)
 IMPVIOUS AREA = 37.00 AC.
 PERVIOUS AREA = 16.75 AC.

(POST DEVELOPMENT)
 IMPVIOUS AREA = 36.5 AC.
 PERVIOUS AREA = 15.79 AC.

CITY OF LAGRANGE
 ENGINEER'S NOTE:
 1. ALL DISTURBED AREAS SHALL BE RESTORED TO ORIGINAL OR BETTER CONDITION.
 2. ALL DISTURBED AREAS SHALL BE RESTORED TO ORIGINAL OR BETTER CONDITION.
 3. ALL DISTURBED AREAS SHALL BE RESTORED TO ORIGINAL OR BETTER CONDITION.
 4. ALL DISTURBED AREAS SHALL BE RESTORED TO ORIGINAL OR BETTER CONDITION.
 5. ALL DISTURBED AREAS SHALL BE RESTORED TO ORIGINAL OR BETTER CONDITION.
 6. ALL DISTURBED AREAS SHALL BE RESTORED TO ORIGINAL OR BETTER CONDITION.
 7. ALL DISTURBED AREAS SHALL BE RESTORED TO ORIGINAL OR BETTER CONDITION.
 8. ALL DISTURBED AREAS SHALL BE RESTORED TO ORIGINAL OR BETTER CONDITION.
 9. ALL DISTURBED AREAS SHALL BE RESTORED TO ORIGINAL OR BETTER CONDITION.
 10. ALL DISTURBED AREAS SHALL BE RESTORED TO ORIGINAL OR BETTER CONDITION.
 11. ALL DISTURBED AREAS SHALL BE RESTORED TO ORIGINAL OR BETTER CONDITION.
 12. ALL DISTURBED AREAS SHALL BE RESTORED TO ORIGINAL OR BETTER CONDITION.
 13. ALL DISTURBED AREAS SHALL BE RESTORED TO ORIGINAL OR BETTER CONDITION.